

BEFORE INSTALLING

Make sure to follow these steps before install the device

Remove the 2 lateral transport **plastic** screws M8x30

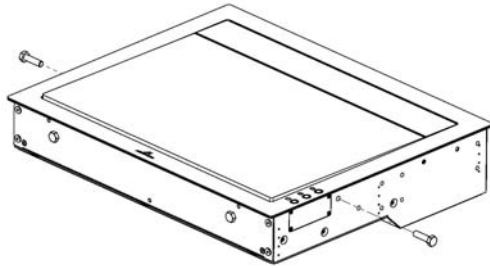

Remove the 2 front transport **plastic** screws M8x30

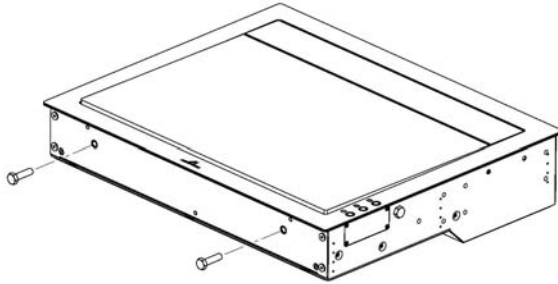

Dynamic3 is ready to be installed.

BEFORE SHIPPING

Follow next steps to pack the device for a safe shipment

For a safety shipment all screws must be of plastic. Otherwise Albiral Display Solutions S.L. is not responsible for damage caused during transport

Close the monitor carefully by hand to the position shown in the next figure

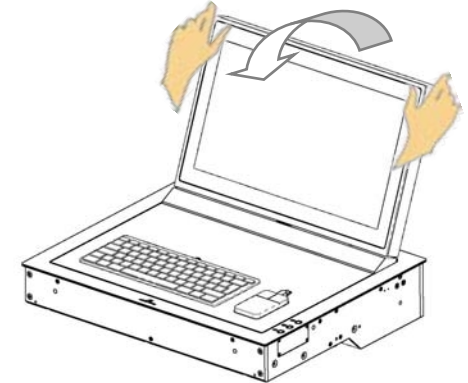

Hold the monitor with the hand between the frame and the monitor housing. At the same time insert the 2 **plastic** screws (M8x30) entirely. To close the monitor leave the monitor housing and it will fall to touch the two **plastic** screws.

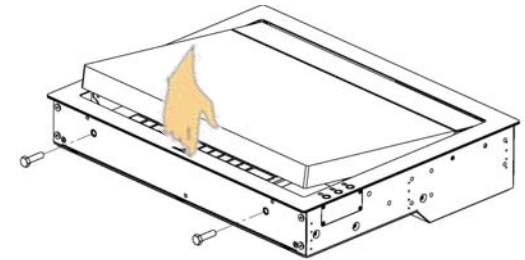

Insert the two lateral **plastic** screws (M8x30) starting by the righthand side, screw the plastic screw into the frame until it touches the aluminium housing without moving the aluminium housing (very fine tolerances) hereafter insert the lefthand side plastic screw by screwing it until it touches the aluminium housing.

